

Catalogue of Products

Wavin Ekoplastik PP-R/PP-RCT Piping System

Water distribution
Heating and cooling



An Orbia business.

2024



Making the sustainable, attainable

Sustainable thinking is good. Sustainable action is better. Better for the communities that we live in. Better for the planet that we share.

As a market leading contributor to the built environment, our sights are firmly set on leading our industry in sustainability by 2025. We're backing this ambition with real investment, real action, real outcomes and real leadership. Ultimately, our goal is to achieve Net Zero Carbon emissions by 2050.

Working with our customers, users and suppliers, we'll design out carbon from every product and process that we're responsible for. Our focus throughout will be to build healthier, more sustainable environments for all.

Our sustainability journey is well and truly underway at Wavin.

Let's work together to help build a better future for generations to come.

Our purpose

Building healthy, sustainable environments

There are four pillars driving our sustainability journey, selected to reflect where we can contribute to the United Nation's published Sustainable Development Goals. These pillars form the foundation of our purpose: to build healthy, sustainable environments.

While we build and create value through our products and services, we do so in a mindful way – by using as much recycled material as possible, reducing energy consumption and waste, and keeping a close eye on our footprint. In other words, doing our utmost to create a sustainable future.

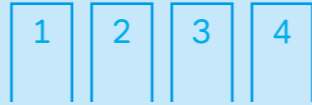

The four pillars form the foundation of our purpose: to build healthy, sustainable environments



Safe and efficient water supply

Future generations face a 40% shortfall between water supply and demand. Alongside other experts, Wavin is working to deliver safe and clean water security through enhanced rainwater reuse, the digitalisation of water management and more secure and durable piping.

Better sanitation and hygiene

Outdated sewer systems are overwhelmed by a triple whammy of urbanisation, population growth and climate change. We're working towards a healthier future with long-lasting sanitation solutions that deliver greater capacity, fewer leaks, less clogging and better monitoring.



Climate resilient cities

Smarter systems are needed to meet the five big challenges our cities face: floods, droughts, heat stress, ground water depletion and surface-water pollution. From roof to river, we are helping with connected water capture, attenuation, cleaning, reuse and transportation solutions to make cities climate resilient.

Better building performance

Constrained by time, cost and product sourcing challenges, many of today's buildings fail to deliver on their expected performance. Through improved digital modelling, we can help our partners predict time and resource needs throughout the building process and provide intelligent solutions for better urban living.



References

Wavin PP-RCT is a tested system that has been widely used all over Europe, Asia, Middle East, and other parts of the world for

decades. It is the number one choice for all professionals as well as owners.



National Theater
Prague, Czech Republic



General sanitation
Male, Maldives



Elementary School
Třanovice, Czech Republic



Serenia Residence The Palm
Dubai, United Arab Emirates



Residential building complex
Bard Lakopark, Hungary



Circular Economy Project
Breda, Netherlands

Product sustainability

At Wavin, we're committed to measuring the real-world impacts of our products and services throughout their life cycle. By assessing their carbon footprint and understanding what effect they have on the environment, we can seek more sustainable alternatives and continue to refine our blueprint for building a better future.

About us



Wavin is a leading global provider of innovative water management solutions for resilient construction.

As an Orbia business and a part of the business group 'Building & Infrastructure', **Wavin offers sustainability-based customer solutions for drinking water, sanitation, climate resilient cities and better building performance.** Redefining today's pipes and fittings industry with durable products and solutions that require less construction to install and innovating sustainable technologies for water collection and management, heating and cooling and a revolutionary road surface. Wavin headquarters are located in Zwolle, the Netherlands and it **serves 80+ countries on three continents with its 66 production sites located in 36 countries.** Wavin employs approximately 12 000 people

Wavin is part of Orbia

Wavin is part of Orbia, a **community of companies bound together by a shared purpose: to advance life around the world.** Orbia is a purpose-led company, passionate about

the challenges that define how people will live and thrive tomorrow. Our decades-long history began as a leading producer of commodities, and through investment and strategic growth we've become a **global leader in polymers, materials, and infrastructure.** Today, we operate in **41 countries and employ more than 22,000 people worldwide.**

Solutions for Drinking Water

Delivering clean water efficiently and safely has become a world-wide problem. Water is lost due to leakages and ageing networks. We need to improve the distribution of clean drinking water from source to tap. We will work towards these goals by **raising the quality and performance of high-pressure water distribution networks, improving safety levels of indoor drinking water supply, and building towards a new (smarter) ways of managing drinking water.**

Wavin Ekoplastik PP-RCT with new dezincification resistant (DZR) lead-free brass

The future of combined fittings



Why Lead-Free Brass? Why DZR?

Lead-Free

- ⌚ EU registration calls for stricter legislation regarding to lead content
- ⌚ Drinking Water Directive is now limiting the use of lead-free alloys for portable water
- ⌚ Wavin, an Orbia business, started the implementation of lead-free brass immediately, ahead of the legislation

Dezincification resistant (DZR)

- ⌚ We had to look for a different way of product protection BUT:
 - ⌚ NickelZinc plating is already forbidden in many countries
 - ⌚ Passivated brass is not sufficient in regions using desalinated water in their water supply
- ⌚ DZR complies with ecological aspects as well as the requirements for the reliability and longevity of our products

We are rocking ON BRASS!



Wavin Ekoplastik PP-R/PP-RCT Piping System

Contents

Utilisation of Wavin Ekoplastik PP-R/PP-RCT Piping System	9
Product Range Basic Information	11
Standard Products for Potable (Cold) and Hot Water and for Heating (I.)	12
Complete Offer of Fittings for Gypsum Wall Mounting (I.)	39
Special Fittings for Heating (I.)	40
Standard Products only for Potable (Cold) Water (II.).....	45
Products for Temporary Use (non Standard) (III.)	47
Accessories (IV.)	48
Wavin Ekoplastik PP-R/PP-RCT Piping System diameters 160-250 mm	56
Products for Potable (Cold) and Hot Water, compressed air, cooling and air conditioning (I.).....	57
Accessories (IV.)	61
Certificates	63

Designation of Pipes S (SDR) instead of PN

Designation of pipes S (SDR) instead of PN in accordance with the ČSN EN ISO 15874 and DIN 8077 standards, it is necessary to designate the pipes as "S" or "SDR" instead of "PN".

$$SDR = 2S + 1$$

$$SDR \approx D/t$$

Legend:

D = outside diameter
t = the wall thickness

- ⌚ The "PN" designation indicates the permissible operating pressure in bar for maximum temperature 20 °C and service life of 50 years.
- ⌚ For the lowest design coefficient according to "PN", the standards ČSN EN ISO 15874 and DIN 8077 no longer specify the pipe classification.
- ⌚ We designate the PPR tubes as "PN" for historical reasons (it used to be the former designation for the pressurised product range) although the values no longer correspond to the definition above.
- ⌚ The PP-RCT is a new type of material and the "PN" designation has not been implemented.
- ⌚ The operating parameters of the pipes are specified in the designation on the tubes and in the Assembly instructions.

The catalogue states the "PN" values for the pipes made of PP-RCT for easier orientation (the "PN" formula as specified in the standard was used in the calculation).

Utilisation of Wavin Ekoplastik PP-RCT Piping System

The Wavin Ekoplastik PP-R/PP-RCT piping system can be used for distribution systems in housing, administration and community buildings as well as for industrial and agricultural installations.

The system is designed for transport of cold and hot water as well as floor heating. In case of observance of the rules specified hereinafter the system is also suitable for central heating systems.

The Wavin Ekoplastik PP-R/PP-RCT piping system can also be used for air distribution. It is possible to take further advantage of its chemical resistance and other system properties and use the system for transport of other liquids or gaseous or solid media; such usage, however, must not be done without a prior individual assessment.

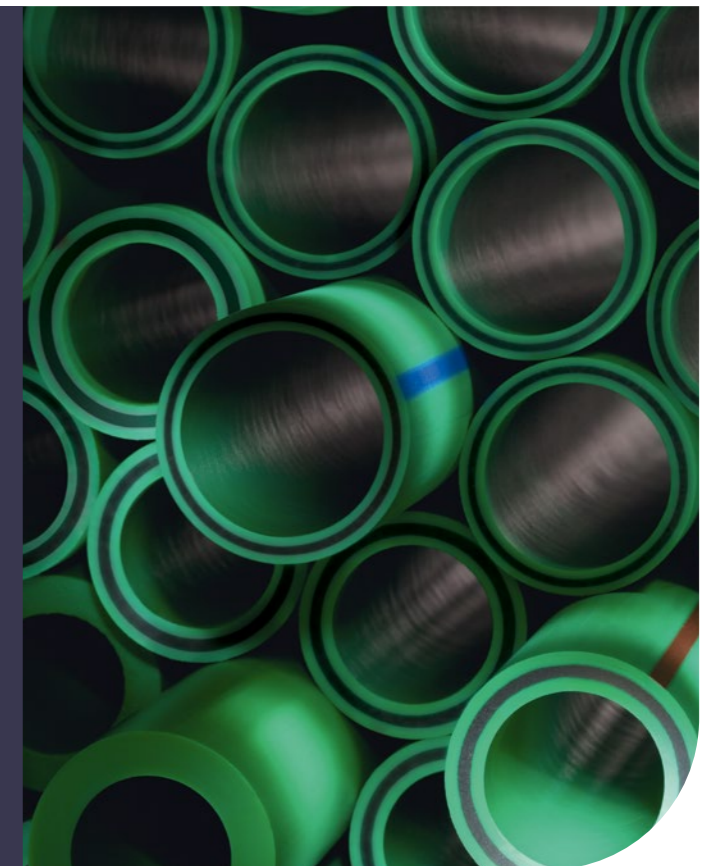

Benefits

- ⌚ complete set of pipes and fittings with sizes 16 - 125 mm
- ⌚ universal for all pipes from the Wavin Ekoplastik PP-RCT system
- ⌚ manufactured from granulate by leading European manufacturers
- ⌚ unique three-layer tube with basalt fibers
- ⌚ 4th generation material – PP-RCT

Wavin Ekoplastik PP-R/PP-RCT Piping System

Product Range - Basic Information

Major Areas of Application of Individual Pipe

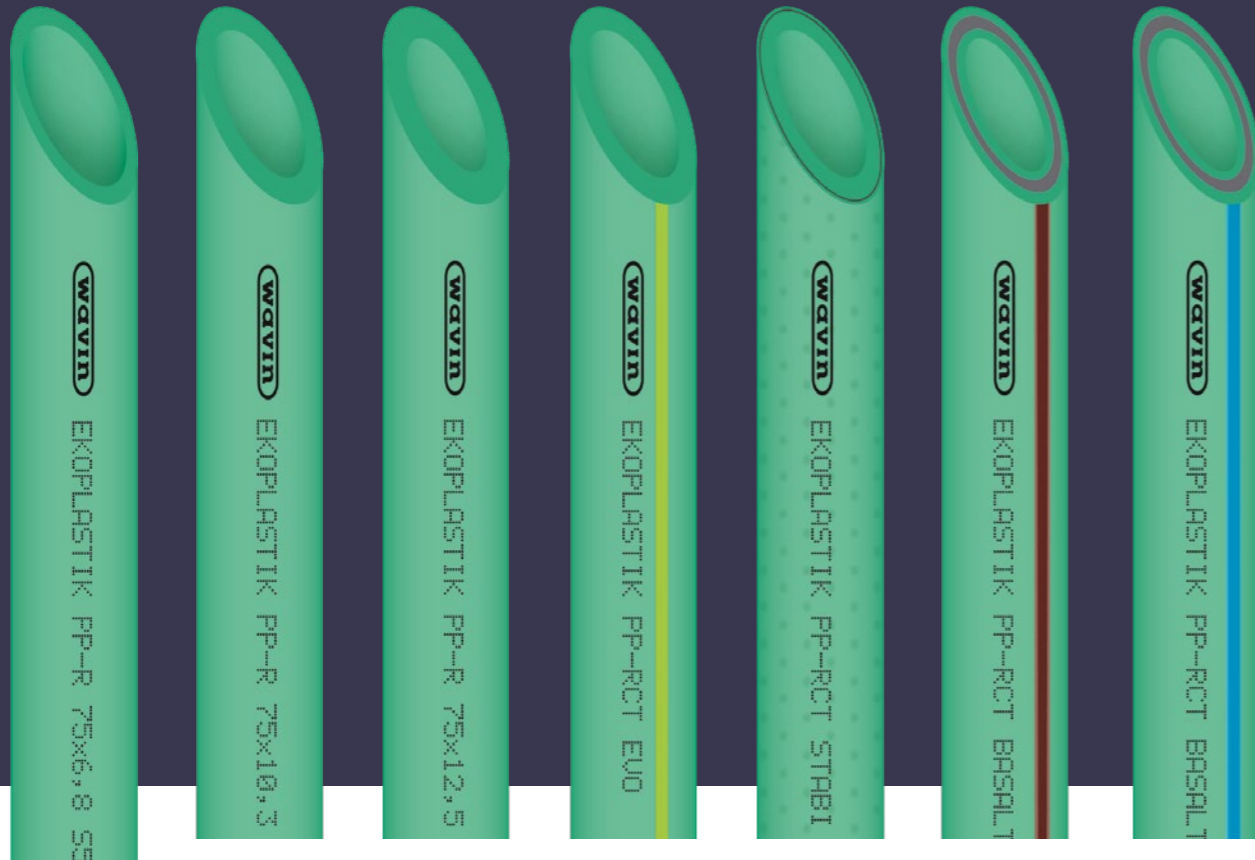

Wavin Ekoplastik PP-R PN10 Ø 20–125 mm	Wavin Ekoplastik PP-R PN16 Ø 16–125 mm	Wavin Ekoplastik PP-R PN20 Ø 16–125 mm	Wavin Ekoplastik PP-RCT EVO PLUS / EVO Ø 16–125 mm	Wavin Ekoplastik PP-RCT Stabi Plus Ø 16–110 mm	Wavin Ekoplastik PP-RCT Fiber Basalt Plus Ø 20–125 mm	Wavin Ekoplastik PP-RCT Fiber Basalt Clima Ø 20–125 mm
---	---	---	---	---	--	---



max. 70 °C

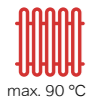

max. 90 °C

Multilayer pipes made from PP-RCT

Multi-layer pipes made of the latest generation material - PP-RCT

Wavin Ekoplastik PP-RCT Stabi Plus

- 3× lesser thermal expansion
- oxygen barrier
- heating

Wavin Ekoplastik PP-RCT Fiber Basalt Plus

- 3× lesser thermal expansion
- no need to shave before welding
- hot water, heating

Wavin Ekoplastik PP-RCT Fiber Basalt Clima

- 3× lesser thermal expansion
- no need to shave before welding
- cold water, air conditioning

Catalogue of Products

Standard Products for Potable (Cold) and Hot Water and for Heating (I.)

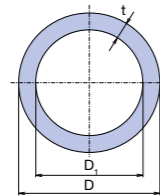

Wavin Ekoplastik PP-R pipe
S 5 / PN 10 / SDR 11

CODE	S	D [mm]	D ₁ [mm]	t [mm]	l [mm]	Packing [m]	Weight [kg/m]
TTR020P10X	5	20	15,6	2,2	4 000	100	0,121
TTR025P10X	5	25	20,4	2,3	4 000	60	0,164
TTR032P10X	5	32	26,2	2,9	4 000	40	0,258
TTR040P10X	5	40	32,6	3,7	4 000	24	0,413
TTR050P10X	5	50	40,8	4,6	4 000	16	0,636
TTR063P10X	5	63	51,4	5,8	4 000	12	1,004
TTR075P10X	5	75	61,4	6,8	4 000	8	1,401
TTR090P10X	5	90	73,6	8,2	4 000	4	2,014
TTR110P10X	5	110	90,0	10,0	4 000	4	3,009
TTR125P10X*	5	125	102,2	11,4	4 000	4	3,910

* Job-order manufacture, delivery date 30 days.

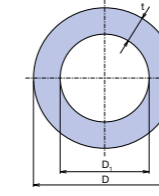

Wavin Ekoplastik PP-R pipe
S 2,5 / PN 20 / SDR 6

CODE	S	D [mm]	D ₁ [mm]	t [mm]	l [mm]	Packing [m]	Weight [kg/m]
TTR016P20X	2,5	16	10,6	2,7	4 000	160	0,107
TTR020P20X	2,5	20	13,2	3,4	4 000	100	0,169
TTR025P20X	2,5	25	16,6	4,2	4 000	60	0,259
TTR032P20X	2,5	32	21,2	5,4	4 000	40	0,423
TTR040P20X	2,5	40	26,6	6,7	4 000	24	0,657
TTR050P20X	2,5	50	33,4	8,3	4 000	16	1,013
TTR063P20X	2,5	63	42,0	10,5	4 000	12	1,611
TTR075P20X	2,5	75	50,0	12,5	4 000	8	2,288
TTR090P20X	2,5	90	60,0	15,0	4 000	4	3,332
TTR110P20X	2,5	110	73,4	18,3	4 000	4	4,977
TTR125P20X	2,5	125	83,4	20,8	4 000	4	6,470

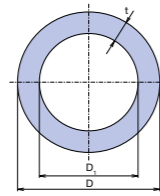

Wavin Ekoplastik PP-R pipe
S 3,2 / PN 16 / SDR 7,4

CODE	S	D [mm]	D ₁ [mm]	t [mm]	l [mm]	Packing [m]	Weight [kg/m]
TTR016P16X	3,2	16	11,6	2,2	4 000	160	0,094
TTR020P16X	3,2	20	14,4	2,8	4 000	100	0,145
TTR025P16X	3,2	25	18,0	3,5	4 000	60	0,227
TTR032P16X	3,2	32	23,2	4,4	4 000	40	0,367
TTR040P16X	3,2	40	29,0	5,5	4 000	24	0,566
TTR050P16X	3,2	50	36,2	6,9	4 000	16	0,886
TTR063P16X	3,2	63	45,8	8,6	4 000	12	1,387
TTR075P16X	3,2	75	54,4	10,3	4 000	8	1,990
TTR090P16X	3,2	90	65,4	12,3	4 000	4	2,839
TTR110P16X	3,2	110	79,8	15,1	4 000	4	4,274
TTR125P16X*	3,2	125	90,8	17,1	4 000	4	5,530

* Job-order manufacture, delivery date 30 days.

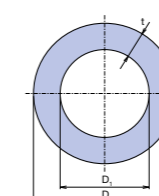

Wavin Ekoplastik PP-R pipe
S 2,5 / PN 20 / SDR 6 – 3 m

CODE	S	D [mm]	D ₁ [mm]	t [mm]	l [mm]	Packing [m]	Weight [kg/m]
TTR020P203	2,5	20	13,2	3,4	3 000	75	0,169
TTR025P203	2,5	25	16,6	4,2	3 000	45	0,259
TTR032P203	2,5	32	21,2	5,4	3 000	30	0,423

All pipes listed above could be manufactured in alternative lengths to special order by prior agreement.

Catalogue of Products

Standard Products for Potable (Cold) and Hot Water and for Heating (I.)

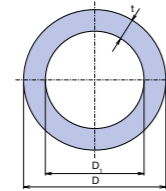

Wavin Ekoplastik PP-RCT Evo pipe
32 - 125 mm – S 4 / SDR 9 / PN 22 (calculation)

CODE	S	D [mm]	D ₁ [mm]	t [mm]	l [mm]	Packing [m]	Weight [kg/m]
TTRE016S32	3,2	16	11,6	2,2	4 000	160	0,095
TTRE020S32	3,2	20	14,4	2,8	4 000	100	0,148
TTRE025S32	3,2	25	18,0	3,5	4 000	60	0,230
TTRE032S4	4	32	24,8	3,6	4 000	40	0,313
TTRE040S4	4	40	31,0	4,5	4 000	24	0,487
TTRE050S4	4	50	38,8	5,6	4 000	16	0,755
TTRE063S4	4	63	48,8	7,1	4 000	12	1,200
TTRE075S4	4	75	58,2	8,4	4 000	8	1,690
TTRE090S4	4	90	69,8	10,1	4 000	4	2,440
TTRE110S4	4	110	85,4	12,3	4 000	4	3,620
TTRE125S4	4	125	97,0	14,0	4 000	4	4,660

For optimal seam, we recommend the welding temperature of 260 °C and the heating time specified in the technical manual for the specific diameter of the pipe.

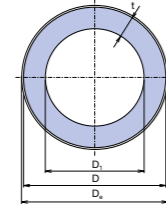

Wavin Ekoplastik PP-RCT Stabi Plus pipe
with perforated aluminum foil
16 - 63 mm – S 3,2 / SDR 7,4 / PN 28 (calculation)
75 - 110 mm – S 4 / SDR 9 / PN 22 (calculation)

CODE	S	D [mm]	D ₀ [mm]	D ₁ [mm]	t [mm]	l [mm]	Packing [m]	Weight [kg/m]
TTRS016RCT	3,2	16	17,9	11,4	2,2	4 000	120	0,137
TTRS020RCT	3,2	20	21,9	14,4	2,8	4 000	80	0,207
TTRS025RCT	3,2	25	26,9	18,0	3,5	4 000	60	0,298
TTRS032RCT	3,2	32	33,9	23,2	4,4	4 000	40	0,465
TTRS040RCT	3,2	40	41,9	29,0	5,5	4 000	20	0,692
TTRS050RCT	3,2	50	52,0	36,2	6,9	4 000	16	1,046
TTRS063RCT	3,2	63	65,0	45,8	8,6	4 000	8	1,587
TTRS075RCT	4	75	77,0	58,2	8,4	4 000	8	1,860
TTRS090RCT	4	90	92,0	69,8	10,1	4 000	4	2,673
TTRS110RCT	4	110	112,0	85,4	12,3	4 000	4	4,022

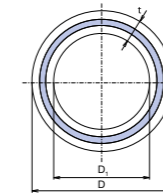
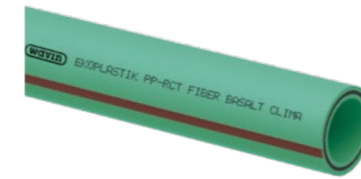

Wavin Ekoplastik PP-RCT Fiber Basalt Plus pipe
20 - 63 mm – S 3,2 / SDR 7,4 / PN 28 (calculation)
75 - 125 mm – S 4 / SDR 9 / PN 22 (calculation)

Diameters 75 - 125 mm SDR 7,4 can be made to order.

CODE	S	D [mm]	D ₁ [mm]	t [mm]	l [mm]	Packing [m]	Weight [kg/m]
TTRFB020TRCT	3,2	20	14,4	2,8	4 000	100	0,153
TTRFB025TRCT	3,2	25	18,0	3,5	4 000	60	0,239
TTRFB032TRCT	3,2	32	23,2	4,4	4 000	40	0,385
TTRFB040TRCT	3,2	40	29,0	5,5	4 000	24	0,599
TTRFB050TRCT	3,2	50	36,2	6,9	4 000	16	0,941
TTRFB063TRCT	3,2	63	45,8	8,6	4 000	12	1,471
TTRFB075TRCT	4	75	58,2	8,4	4 000	8	1,764
TTRFB090TRCT	4	90	69,8	10,1	4 000	4	2,546
TTRFB110TRCT	4	110	85,4	12,3	4 000	4	3,781
TTRFB125TRCT*	4	125	97,0	14,0	4 000	4	4,891

* Job-order manufacture, delivery date 30 days.

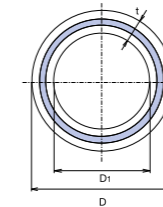

Wavin Ekoplastik PP-RCT Fiber Basalt Clima pipe
20 - 25 mm – S 4 / SDR 9 / PN 22 (calculation)
32 - 125 mm – S 5 / SDR 11 / PN 18 (calculation)

CODE	S	D [mm]	D ₁ [mm]	t [mm]	l [mm]	Packing [m]	Weight [kg/m]
TTRFBC020TRCT	4	20	15,4	2,3	4 000	100	0,128
TTRFBC025TRCT	4	25	19,4	2,8	4 000	60	0,199
TTRFBC032TRCT	5	32	26,2	2,9	4 000	40	0,269
TTRFBC040TRCT	5	40	32,6	3,7	4 000	24	0,428
TTRFBC050TRCT	5	50	40,8	4,6	4 000	16	0,664
TTRFBC063TRCT	5	63	51,4	5,8	4 000	12	1,050
TTRFBC075TRCT*	5	75	61,4	6,8	4 000	8	1,501
TTRFBC090TRCT*	5	90	73,6	8,2	4 000	4	2,122
TTRFBC110TRCT*	5	110	90,0	10,0	4 000	4	3,160
TTRFBC125TRCT*	5	125	102,2	11,4	4 000	4	4,082

* Job-order manufacture, delivery date 30 days.

Catalogue of Products

Standard Products for Potable (Cold) and Hot Water and for Heating (I.)

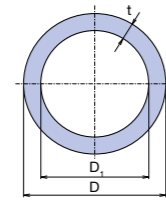

Pipe in Coil

CODE 100 m	CODE 200 m	S (PN)	SDR	D [mm]	t [mm]	l [m]	Packing	Weight [kg/m]
TTRK016P17		3,2 (16)	7,4	16	2,2	100	1	0,094
TTRK020P11	TTRK020P10	5,0 (10)	11	20	2,2	100 / 200	1	0,121
TTRK020P17	TTRK020P16	3,2 (16)	7,4	20	2,8	100 / 200	1	0,145
TTRK016P21	TTRK016P20	2,5 (20)	6	16	2,7	100 / 200	1	0,107
TTRK020P21	TTRK020P20	2,5 (20)	6	20	3,4	100 / 200	1	0,169

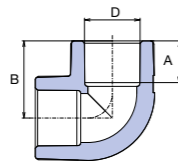

Elbow 90°

CODE	D [mm]	A [mm]	B [mm]	Packing I.	Packing II.	Weight [kg/pc]
TKO01690XX	116	13,0	123,2	20	280	0,010
TKO02090RCT*	120	14,5	126,8	20	260	0,018
TKO02590RCT*	125	16,0	131,0	20	140	0,030
TKO03290RCT*	32	18,0	36,5	10	90	0,039
TKO04090RCT*	40	20,5	43,0	5	50	0,066
TKO05090RCT*	50	23,5	51,0	10	30	0,125
TKO06390RCT*	63	27,5	60,0	5	15	0,240
TKO07590RCT*	75	30,0	70,1	1	6	0,399
TKO09090RCT*	90	33,0	80,6	1	6	0,600
TKO11090RCT*	110	37,0	94,6	1	4	1,016
TKO12590RCT**	125	40,0	106,6	1	2	1,481

* Material PP-RCT.

** Information about delivery on request.

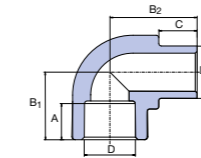

Elbow 90° Internal / External

CODE	D, D ₃ [mm]	A [mm]	B ₁ [mm]	B ₂ [mm]	C [mm]	Packing I.	Packing II.	Weight [kg/pc]
TKO116XXXX	116	13,0	21,3	25,0	12,0	20	340	0,006
TKO120RCT*	120	14,5	26,8	30,3	13,0	20	260	0,014
TKO125RCT*	125	16,0	31,0	35,0	14,0	20	180	0,024
TKO132RCT*	32	18,0	36,5	42,2	16,0	20	120	0,033

* Material PP-RCT.

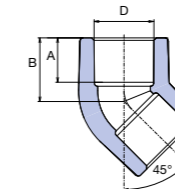

Elbow 45°

CODE	D [mm]	A [mm]	B [mm]	Packing I.	Packing II.	Weight [kg/pc]
TKO01645XX	116	13,0	18,7	20	300	0,008
TKO02045RCT*	120	14,5	20,8	20	300	0,014
TKO02545RCT*	125	16,0	24,0	20	160	0,024
TKO03245RCT*	32	18,0	27,0	10	100	0,030
TKO04045RCT*	40	20,5	31,5	5	60	0,052
TKO05045RCT*	50	23,5	36,5	5	20	0,092
TKO06345RCT*	63	27,5	43,0	5	10	0,188
TKO07545RCT*	75	30,0	48,1	2	6	0,272
TKO09045RCT*	90	33,0	54,5	1	6	0,406
TKO11045RCT*	110	37,0	62,1	1	6	0,709
TKO12545RCT**	125	40,0	69,8	1	3	1,048

* Material PP-RCT.

** Information about delivery on request.

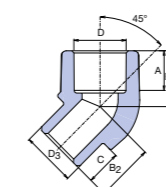

Elbow 45° Internal / External

CODE	D, D ₃ [mm]	A [mm]	B ₁ [mm]	B ₂ [mm]	C [mm]	Packing I.	Packing II.	Weight [kg/pc]
TKO11645XX	116	13,0	18,7	18,7	12,0	10	300	0,008
TKO12045RCT*	120	14,5	20,8	21,5	13,0	10	280	0,012
TKO12545RCT*	125	16,0	24,0	24,0	14,0	10	100	0,026
TKO13245RCT*	32	18,0	27,0	27,0	16,0	20	120	0,032

* Material PP-RCT.

Catalogue of Products

Standard Products for Potable (Cold) and Hot Water and for Heating (I.)

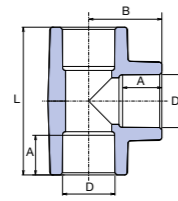

Tee

CODE	D [mm]	A [mm]	B [mm]	L [mm]	Packing I.	Packing II.	Weight [kg/pc]
TTK016XXXX	116	13,0	23,2	46,4	20	140	0,012
TTK020RCTX*	120	14,5	27,0	54,0	20	180	0,022
TTK025RCTX*	125	16,0	32,0	60,0	20	100	0,038
TTK032RCTX*	32	18,0	35,7	73,0	10	60	0,049
TTK040RCTX*	40	20,5	38,5	86,2	5	40	0,084
TTK050RCTX*	50	23,5	51,0	102,0	5	20	0,158
TTK063RCTX*	63	27,5	61,5	123,0	5	10	0,317
TTK075RCTX*	75	30,0	70,1	140,2	1	6	0,485
TTK090RCTX*	90	33,0	80,6	161,2	1	6	0,742
TTK110RCTX*	110	37,0	94,6	189,2	1	3	1,231
TTK125RCTX**	125	40,0	105,5	211,0	1	2	1,764

* Material PP-RCT.

** Information about delivery on request

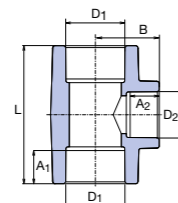

Reducing Tee

CODE	D ₁ [mm]	D ₂ [mm]	A ₁ [mm]	A ₂ [mm]	L [mm]	B [mm]	Packing I.	Packing II.	Weight [kg/pc]
TTKR02016X	20	16	14,5	13,0	53,0	23,0	20	160	0,018
TTKR02520RCT*	25	20	16,0	14,5	55,0	29,0	20	160	0,032
TTKR03220RCT*	32	20	18,0	14,5	67,0	34,4	10	80	0,035
TTKR03225RCT*	32	25	18,0	16,0	66,0	34,4	10	70	0,037
TTKR04020RCT*	40	20	20,5	14,5	66,0	37,0	10	50	0,056
TTKR04025RCT*	40	25	20,5	16,0	71,0	38,5	10	50	0,062
TTKR04032RCT*	40	32	20,5	18,0	78,0	41,5	5	40	0,071
TTKR05025RCT*	50	25	23,5	16,0	77,0	43,0	5	40	0,104
TTKR05032RCT*	50	32	23,5	18,0	84,0	46,0	5	20	0,116
TTKR05040RCT*	50	40	23,5	20,5	92,0	48,0	5	15	0,132
TTKR06325RCT*	63	25	27,5	16,0	85,0	49,9	5	10	0,167
TTKR06332RCT*	63	32	27,5	18,0	92,0	52,0	5	20	0,195
TTKR06340RCT*	63	40	27,5	20,5	100,0	54,6	5	20	0,230
TTKR06350RCT*	63	50	27,5	23,5	110,0	57,2	5	15	0,255
TTKR07540RCT*	75	40	30,0	20,5	115,4	63,5	1	6	0,382
TTKR07550RCT*	75	50	30,0	23,5	115,4	63,5	1	6	0,360
TTKR07563RCT*	75	63	30,0	27,5	128,4	67,5	1	6	0,360
TTKR09075RCT*	90	75	33,0	30,0	146,2	77,7	1	2	0,605

* Material PP-RCT.

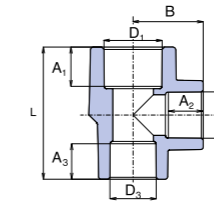

Reducing Tee

CODE	D ₁ [mm]	D ₂ [mm]	D ₃ [mm]	A ₁ [mm]	A ₂ [mm]	A ₃ [mm]	L [mm]	B [mm]	Packing I.	Packing II.	Weight [kg/pc]
TTKR0252020RCT*	25	20	20	16,0	14,5	14,5	55,2	29,3	10	120	0,028
TTKR0322020RCT*	32	20	20	18,0	14,5	14,5	57,3	32,8	10	50	0,040
TTKR0322025RCT*	32	20	25	18,0	14,5	16,0	58,9	32,8	10	50	0,044
TTKR0322525RCT*	32	25	25	18,0	18,0	16,0	66,0	34,4	10	50	0,052

* Material PP-RCT.

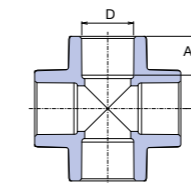

Cross Piece

CODE	D [mm]	A [mm]	B [mm]	Packing I.	Packing II.	Weight [kg/pc]
TKRI020RCT*	20	14,5	26,3	20	100	0,024
TKRI025RCT*	25	16,0	30,1	20	100	0,042
TKRI032RCT*	32	18,0	35,0	10	40	0,070
TKRI040RCT*	40	20,5	42,0	10	30	0,128

* Material PP-RCT.

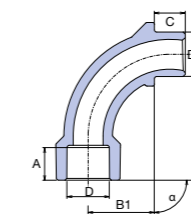

Bend

CODE	D [mm]	D ₃ [mm]	A [mm]	B ₁ [mm]	B ₂ [mm]	C [mm]	α	Packing I.	Packing II.	Weight [kg/pc]
TO02090RCT*	20	20	14,5	30,0	56,0	13,6	90°	20	140	0,022
TO02590RCT*	25	25	16,0	38,0	67,0	14,6	90°	10	100	0,036
TO03290RCT*	32	32	18,0	38,0	69,0	15,9	90°	10	80	0,043

* Material PP-RCT.

Catalogue of Products

Standard Products for Potable (Cold) and Hot Water and for Heating (I.)

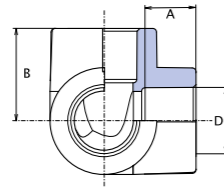

Three-Way Elbow

CODE	D [mm]	A [mm]	B [mm]	Packing I.	Packing II.	Weight [kg/pc]
TKOT020XXX	20	14,5	26,8	10	50	0,020
TKOT025XXX	25	16,0	29,5	10	40	0,032
TKOT032RCT*	32	18,0	35,0	15	20	0,062
TKOT040RCT*	40	20,5	41,5	15	15	0,108

* Material PP-RCT.

CODE	D [mm]	A [mm]	B [mm]	Packing I.	Packing II.	Weight [kg/pc]
TKRIO20RCT*	20	14,5	26,8	10	100	0,020
TKRIO25RCT*	25	16,0	29,5	10	80	0,032
TKRIO32RCT*	32	18,0	35,0	5	40	0,062
TKRIO40RCT*	40	20,5	41,5	5	30	0,108

* Material PP-RCT.

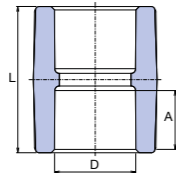

Socket

CODE	D [mm]	A [mm]	L [mm]	Packing I.	Packing II.	Weight [kg/pc]
TNA016XXXX	116	13,0	33,0	20	280	0,006
TNA020RCTX*	120	14,5	34,6	20	360	0,010
TNA025RCTX*	125	16,0	37,8	20	220	0,018
TNA032RCTX*	32	18,0	42,0	20	120	0,030
TNA040RCTX*	40	20,5	48,0	10	80	0,041
TNA050RCTX*	50	23,5	54,0	10	70	0,061
TNA063RCTX*	63	27,5	63,0	5	30	0,127
TNA075RCTX*	75	30,0	68,0	1	25	0,172
TNA090RCTX*	90	33,0	74,2	1	12	0,275
TNA110RCTX*	110	37,0	85,2	1	4	0,472
TNA125RCTX**	125	40,0	93,0	1	6	0,638

* Material PP-RCT.

** Information about delivery on request

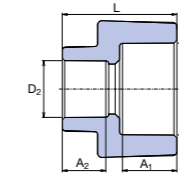

Reducer

CODE	D ₁ [mm]	D ₂ [mm]	A ₁ [mm]	A ₂ [mm]	L [mm]	Packing I.	Packing II.	Weight [kg/pc]
TRE02520RCT*	25	20	16,0	14,5	34,0	20	260	0,014
TRE03220RCT*	32	20	18,0	14,5	38,0	20	160	0,018
TRE03225RCT*	32	25	18,0	16,0	40,0	20	140	0,019

* Material PP-RCT.

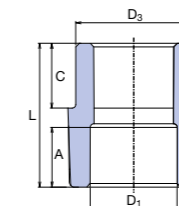

Reducer Internal / External

CODE	D ₃ [mm]	D ₁ [mm]	A [mm]	L [mm]	C [mm]	Packing I.	Packing II.	Weight [kg/pc]
TRE12016XX	120	16	13,0	32,5	13,0	20	300	0,006
TRE12520RCT*	125	20	14,5	34,0	14,0	20	360	0,010
TRE13220RCT*	32	20	14,5	34,0	16,0	20	300	0,012
TRE13225RCT*	32	25	16,0	35,0	16,0	20	200	0,013
TRE14020RCT*	40	20	14,5	36,3	18,5	10	150	0,021
TRE14025RCT*	40	25	16,0	38,3	18,5	10	150	0,022
TRE14032RCT*	40	32	18,0	41,3	18,5	20	160	0,023
TRE15025RCT*	50	25	16,0	41,3	21,3	10	60	0,035
TRE15032RCT*	50	32	18,0	43,3	21,3	10	60	0,035
TRE15040RCT*	50	40	20,5	43,3	21,3	10	80	0,035
TRE16325RCT*	63	25	16,0	45,3	25,3	5	60	0,060
TRE16332RCT*	63	32	18,0	47,3	25,3	5	60	0,056
TRE16340RCT*	63	40	20,5	44,3	25,3	5	60	0,058
TRE16350RCT*	63	50	23,5	54,0	25,3	5	50	0,076
TRE17540RCT*	75	40	20,5	56,9	28,9	5	20	0,094
TRE17550RCT*	75	50	23,5	51,4	28,9	5	20	0,100
TRE17563RCT*	75	63	27,5	62,9	28,9	1	20	0,112
TRE19050RCT*	90	50	23,5	57,9	33,4	1	30	0,157
TRE19063RCT*	90	63	27,5	56,9	33,4	1	25	0,150
TRE19075RCT*	90	75	30,0	69,4	33,4	1	20	0,185
TRE111075RCT*	110	75	30,0	60,5	39,4	1	12	0,251
TRE111090RCT*	110	90	33,0	79,4	39,4	1	12	0,303
TRE1125110RCT**	125	110	37,0	100,3	42,0	1	10	0,500

* Material PP-RCT.

** Information about delivery on request

Catalogue of Products

Standard Products for Potable (Cold) and Hot Water and for Heating (I.)

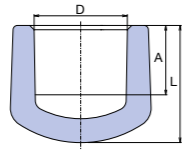

End Plug

CODE	D [mm]	A [mm]	L [mm]	Packing I.	Packing II.	Weight [kg/pc]
TZA016XXX	16	13,5	20,9	20	180	0,004
TZA020RCTX*	20	14,5	24,5	20	280	0,008
TZA025RCTX*	25	16,0	28,0	20	240	0,014
TZA032RCTX*	32	18,0	30,0	20	240	0,016
TZA040RCTX*	40	20,5	34,0	5	80	0,032
TZA050RCTX*	50	23,5	40,0	5	35	0,061
TZA063RCTX*	63	27,5	46,5	5	30	0,105
TZA075RCTX*	75	30,0	55,5	5	20	0,183
TZA090RCTX*	90	33,0	61,7	1	15	0,279
TZA110RCTX*	110	37,0	71,4	1	5	0,480
TZA125RCTX**	125	40,0	79,5	1	4	0,712

* Material PP-RCT.

** Information about delivery on request.

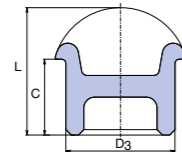

End Plug Internal

CODE	D ₃ [mm]	C [mm]	L [mm]	Packing I.	Packing II.	Weight [kg/pc]
TZA120RCTE*	20	14,3	23,5	20	500	0,004

* Material PP-RCT.

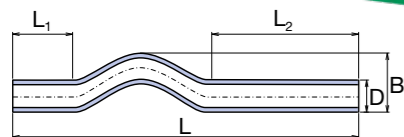

Crossover
S 2,5 / PN 20 / SDR 6

CODE	D [mm]	S	B [mm]	L [mm]	L ₁ [mm]	L ₂ [mm]	Packing I.	Packing II.	Weight [kg/pc]
TKR016P20X	16	2,5	35,0	400,0	80,0	180,0	10	60	0,044
TKR020RCTX	20	3,2	47,0	400,0	80,0	180,0	10	50	0,070
TKR025RCTX	25	3,2	52,0	400,0	80,0	120,0	10	50	0,110
TKR032RCTX	32	3,2	65,0	390,0	64,0	106,0	5	20	0,174
TKR040RCTX	40	3,2	65,0	390,0	64,0	106,0	5	20	0,268

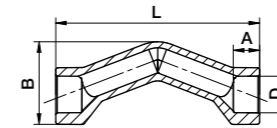

Crossover with Socket

CODE	D [mm]	S (PN)	A [mm]	B [mm]	L [mm]	Packing I.	Packing II.	Weight [kg/pc]
TKRH020P20RCT*	20	2,5 (20)	14,5	42,6	117,0	10	80	0,031
TKRH025P20RCT*	25	2,5 (20)	16,0	54,8	135,0	10	50	0,060
TKRH032P20RCT*	32	2,5 (20)	18,0	69,4	200,0	10	30	0,099

* Material PP-RCT.v

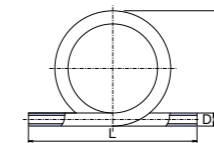

Compensation Pipe
S 2,5 / PN 20 / SDR 6

CODE	D [mm]	S	B [mm]	L [mm]	Packing I.	Packing II.	Weight [kg/pc]
TKS016P20X	16	2,5	185,0	320,0	10	10	0,090
TKS020RCTX	20	3,2	200,0	450,0	10	10	0,174
TKS025RCTX	25	3,2	210,0	440,0	10	10	0,264
TKS032RCTX	32	3,2	230,0	410,0	1	5	0,430
TKS040RCTX	40	3,2	290,0	450,0	1	5	0,786

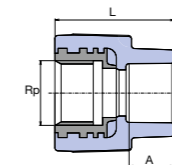

Reducing Sleeve with Metal Female Thread

CODE	D [mm]	Rp	A [mm]	L [mm]	Packing I.	Packing II.	Weight [kg/pc]
TZI01620XX	16	1/2"	13,0	38,0	10	150	0,050
TZI02020RCT*	20	1/2"	14,5	39,0	10	250	0,056
TZI02025RCT*	20	3/4"	14,5	42,0	10	120	0,072
TZI02520RCT*	25	1/2"	16,0	40,5	10	100	0,062
TZI02525RCT*	25	3/4"	16,0	47,0	10	100	0,075
TZI03225RCT*	32	3/4"	18,0	45,0	10	100	0,081
TZI03232OKRCT**	32	1"	18,0	51,0	10	40	0,148
TZI04040RCT**	40	5/4"	20,5	65,5	5	30	0,260
TZI05050RCT**	50	6/4"	23,5	66,0	4	20	0,328
TZI06363RCT**	63	2"	27,5	72,5	2	14	0,616
TZI07575RCT**	75	2 1/2"	28,0	65,5	1	8	0,676
TZI09090RCT**	90	3"	32,0	90,0	1	5	0,954

* Material PP-RCT, lead-free brass.

** With octagon.

Catalogue of Products

Standard Products for Potable (Cold) and Hot Water and for Heating (I.)

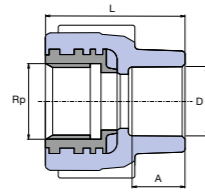

Reducing Sleeve with Metal Female Thread with Cross

CODE	D [mm]	Rp	A [mm]	L [mm]	Packing I.	Packing II.	Weight [kg/pc]
TZIO2020KRCT	20	1/2"	14,5	42,0	10	150	0,058

* Material PP-RCT, lead-free brass.

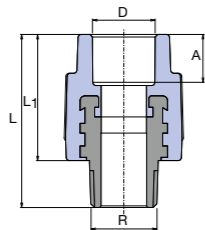

Reducing Sleeve with Metal Male Thread

CODE	D [mm]	R	A [mm]	L [mm]	L ₁ [mm]	Packing I.	Packing II.	Weight [kg/pc]
TZE01620XX	16	1/2"	13,0	52,0	37,5	10	120	0,064
TZE02020RCT *	20	1/2"	14,5	53,5	39,0	10	140	0,062
TZE02025RCT *	20	3/4"	14,5	58,0	40,0	10	100	0,096
TZE02520RCT *	25	1/2"	16,0	55,5	41,0	10	100	0,066
TZE02525RCT *	25	3/4"	16,0	59,0	41,0	10	90	0,098
TZE03225RCT *	32	3/4"	18,0	60,0	44,0	10	100	0,105
TZE03232RCT *	32	1"	18,0	62,5	46,0	10	50	0,170
TZE03232OKRCT **	32	1"	18,0	69,5	42,0	10	50	0,204
TZE04040RCT **	40	5/4"	20,5	77,5	47,5	5	30	0,312
TZE05050RCT **	50	6/4"	23,5	81,6	51,0	4	20	0,460
TZE06363RCT **	63	2"	27,5	93,5	58,0	2	12	0,758
TZE07575RCT **	75	2 1/2"	30,0	110,0	69,7	1	8	0,885
TZE09090RCT **	90	3"	33,0	113,5	73,0	1	6	1,228

* Material PP-RCT, lead-free brass.

** With octagon.

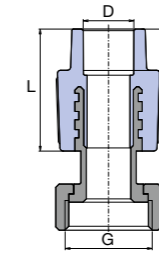

Metal Reducer with Cap Nut

CODE	D [mm]	G	A [mm]	L [mm]	Packing I.	Packing II.	Weight [kg/pc]
TZM01620XX	16	1/2"	13,0	32,0	10	200	0,044
TZM01625XX	16	3/4"	13,0	32,0	10	180	0,082
TZM02020XX	20	1/2"	14,5	40,0	20	200	0,048
TZM02025XX	20	3/4"	14,5	39,0	20	120	0,082
TZM02032XX	20	1"	14,5	39,0	5	80	0,152
TZM02525XX	25	3/4"	16,0	41,1	20	120	0,086
TZM02532XX	25	1"	16,0	41,0	4	80	0,154
TZM03240XX	32	5/4"	18,0	48,0	2	40	0,254

PMD *

TZMD02025X	20	3/4"	14,5	39,0	10	120	0,084
------------	----	------	------	------	----	-----	-------

* PMD – cap nut with the hole for the seal.

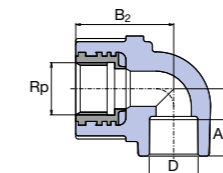

Elbow 90° with Metal Female Thread

CODE	D [mm]	Rp	A [mm]	B ₁ [mm]	B ₂ [mm]	Packing I.	Packing II.	Weight [kg/pc]
TKOI01620X	16	1/2"	13,0	25,2	31,0	10	120	0,062
TKOI02020RCT *	20	1/2"	14,5	27,0	34,5	10	100	0,062
TKOI02025RCT *	20	3/4"	14,5	27,0	40,0	10	80	0,082
TKOI02520RCT *	25	1/2"	16,0	31,0	36,0	10	100	0,070
TKOI02525RCT *	25	3/4"	16,0	30,0	41,0	10	70	0,090
TKOI03232RCT *	32	1"	18,0	36,0	51,0	10	40	0,168

* Material PP-RCT, lead-free brass.

Catalogue of Products

Standard Products for Potable (Cold) and Hot Water and for Heating (I.)

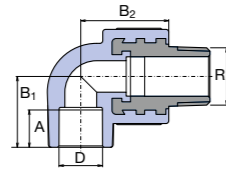

Elbow 90° with Metal Male Thread

CODE	D [mm]	Rp	A [mm]	B ₁ [mm]	B ₂ [mm]	Packing I.	Packing II.	Weight [kg/pc]
TKOE01620X	16	1/2"	13,0	25,2	31,0	10	100	0,074
TKOE02020RCT*	20	1/2"	14,5	27,0	34,5	10	100	0,074
TKOE02025RCT*	20	3/4"	14,5	27,0	39,0	10	70	0,112
TKOE02520RCT*	25	1/2"	16,0	31,0	36,0	10	100	0,082
TKOE02525RCT*	25	3/4"	16,0	30,0	39,0	10	60	0,116
TKOE03232RCT*	32	1"	18,0	36,0	41,6	5	40	0,118

* Material PP-RCT, lead-free brass.

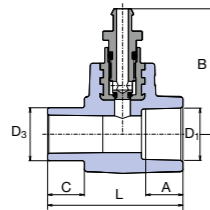

Socket with Drain Valve Internal / External

CODE	D [mm]	D ₃ [mm]	A [mm]	L [mm]	B [mm]	C [mm]	Packing I.	Packing II.	Weight [kg/pc]
TNAV120XX	20	20	14,5	53,0	48,0	13,0	10	100	0,054
TNAV125XX	25	25	16,0	54,0	49,7	14,0	5	150	0,064
TNAV132XX	32	32	18,0	59,0	53,2	16,0	5	100	0,084

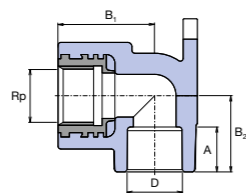

Elbow 90° for Wall Mounting

CODE	D [mm]	Rp	A [mm]	B ₁ [mm]	B ₂ [mm]	Packing I.	Packing II.	Weight [kg/pc]
TNK016XXXX	16	1/2"	13,0	32,0	23,2	10	100	0,064
TNK020XRCT*	20	1/2"	14,5	34,0	26,8	10	120	0,068
TNK02520RCT*	25	1/2"	16,0	36,0	27,5	10	80	0,072
TNK025XRCT*	25	3/4"	16,0	39,0	29,5	10	50	0,098

* Material PP-RCT, lead-free brass.

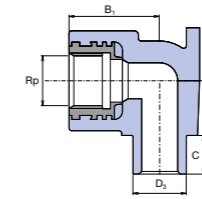

Elbow 90° for Wall Mounting Internal / External

CODE	D [mm]	Rp	B ₁ [mm]	B ₂ [mm]	C [mm]	Packing I.	Packing II.	Maca [кг/6р]
SNK120XRCT*	20	1/2"	35,0	35,0	11,0	10	80	0,068

* Material PP-RCT, lead-free brass.

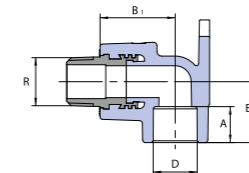

Elbow 90° for Wall Mounting with Metal Male Thread

CODE	D [mm]	Rp	B ₁ [mm]	B ₂ [mm]	A [mm]	Packing I.	Packing II.	Weight [kg/pc]
TNKE02020RCT*	20	1/2"	34,0	32,2	14,5	10	115	0,072

* Material PP-RCT, lead-free brass.

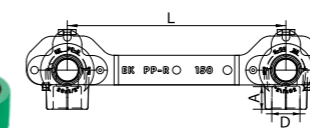

Wall Elbows with Holder

CODE	D [mm]	Rp	A [mm]	L [mm]	Packing I.	Packing II.	Weight [kg/pc]
TNKD02020RCT*	20	1/2"	14,5	150	10	50	0,162

* Material PP-RCT, lead-free brass.



Holder for Wall Elbows

CODE	D [mm]	L [mm]	Packing I.	Packing II.	Weight [kg/pc]
TDNKXXXXXX	20	150	10	100	0,026

* Material PP-RCT, lead-free brass.

Catalogue of Products

Standard Products for Potable (Cold) and Hot Water and for Heating (I.)

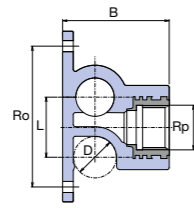

Tee with Tap Connector

CODE	D [mm]	Rp [mm]	B [mm]	Ro [mm]	L [mm]	Packing I.	Packing II.	Weight [kg/pc]
TNKP020XRCT	20	1/2"	50,0	66,0	28,5	10	100	0,080
TNKP02520RCT	25	1/2"	56,0	76,0	33,5	10	60	0,090

Material PP-RCT, lead-free brass.

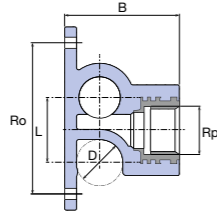

Ending Wall Elbow Left

CODE	D [mm]	Rp [mm]	B [mm]	Ro [mm]	L [mm]	Packing I.	Packing II.	Weight [kg/pc]
TNK020KPxRCT	20	1/2"	50,0	66,0	28,5	5	80	0,066

Material PP-RCT, lead-free brass.

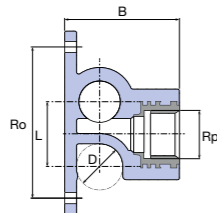

Ending Wall Elbow Right

CODE	D [mm]	Rp [mm]	B [mm]	Ro [mm]	L [mm]	Packing I.	Packing II.	Weight [kg/pc]
TNK020KLXRCT	20	1/2"	50,0	66,0	28,5	5	80	0,066

Material PP-RCT, lead-free brass.

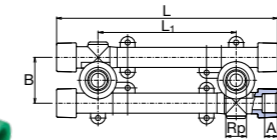

Wall Mounting Group with Tap Connectors

CODE	D [mm]	Rp [mm]	A [mm]	B [mm]	L ₁ [mm]	L [mm]	Packing I.	Packing II.	Weight [kg/pc]
TNKK020RCT	20	1/2"	14,5	46,0	105/130/145	229,0	1	15	0,220
TNKK025RCT	25	1/2"	16,0	51,0	110/125/140	230,0	1	10	0,268

Material PP-RCT, lead-free brass.

* L1 – extension 100, 135, 150 mm, it is necessary to set right with eccentric parts.

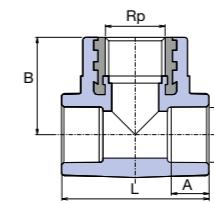

Tee with Metal Female Thread

CODE	D [mm]	Rp [mm]	A [mm]	L [mm]	B [mm]	Packing I.	Packing II.	Weight [kg/pc]
TTKI02020RCT	20	1/2"	14,5	51,5	34,0	10	100	0,068
TTKI02520RCT	25	1/2"	16,0	80,0	40,0	10	80	0,076
TTKI02525RCT	25	3/4"	16,0	80,0	40,0	5	60	0,094
TTKI03220RCT	32	1/2"	18,0	71,0	40,5	5	40	0,106
TTKI03225RCT	32	3/4"	18,0	71,0	42,0	5	30	0,118
TTKI03232RCT	32	1"	18,0	80,0	55,0	5	25	0,186

Material PP-RCT, lead-free brass.

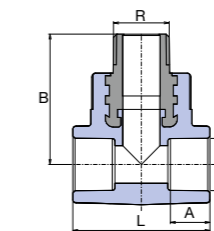

Tee with Metal Male Thread

CODE	D [mm]	Rp [mm]	A [mm]	L [mm]	B [mm]	Packing I.	Packing II.	Weight [kg/pc]
TTKE02020RCT	20	1/2"	14,5	51,5	48,5	10	100	0,080
TTKE02025RCT	20	3/4"	14,5	60,0	50,0	5	60	0,118
TTKE02520RCT	25	1/2"	16,0	60,0	51,0	10	60	0,088
TTKE02525RCT	25	3/4"	16,0	65,0	52,5	5	60	0,122
TTKE03225RCT	32	3/4"	18,0	71,0	58,3	5	40	0,146
TTKE03232RCT	32	1"	18,0	80,0	60,0	5	25	0,208

Material PP-RCT, lead-free brass.

Catalogue of Products

Standard Products for Potable (Cold) and Hot Water and for Heating (I.)

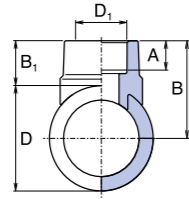

PP-RCT Weld in Saddle

CODE	D [mm]	D ₁ [mm]	A [mm]	B ₁ [mm]	B [mm]	Packing I.	Packing II.	Weight [kg/pc]
TNS06332RCT*	63	32	18,0	21,3	55,0	10	100	0,022
TNS07532RCT*	75	32	18,0	21,3	61,0	10	100	0,023
TNS09032RCT*	90	32	18,0	21,3	69,0	10	100	0,024
TNS11032RCT*	110	32	18,0	25,7	80,7	10	60	0,034
TNS11040RCT*	110	40	21,0	25,7	80,7	10	60	0,036
TNS12532RCT**	125	32	18,0	22,0	84,5	10	60	0,033
TNS12540RCT**	125	40	21,0	28,0	90,5	10	60	0,038
TNS12550RCT**	125	50	23,5	29,5	92,0	5	20	0,043
TNS12563RCT**	125	63	27,5	37,0	99,5	5	20	0,048

* Material PP-RCT.

** Information about delivery on request

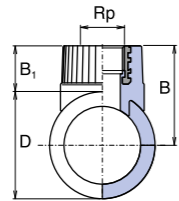

Weld in Saddle with Metal Female Thread

CODE	D [mm]	Rp	B ₁ [mm]	B [mm]	Packing I.	Packing II.	Weight [kg/pc]
TNSI06325X	63	3/4"	27,0	58,5	10	80	0,084
TNSI07525X	75	3/4"	27,0	64,5	10	80	0,084
TNSI09025X	90	3/4"	27,0	72,0	10	80	0,084

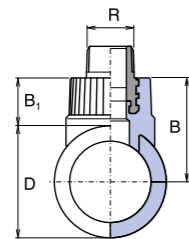

Weld in Saddle with Metal Male Thread

CODE	D [mm]	Rp	B ₁ [mm]	B [mm]	Packing I.	Packing II.	Weight [kg/pc]
TNSE06325X	63	3/4"	44,8	76,3	10	70	0,112
TNSE07525X	75	3/4"	44,8	82,3	10	70	0,110
TNSE09025X	90	3/4"	44,8	89,8	10	70	0,110

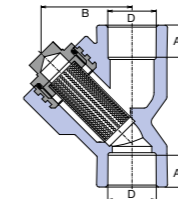

Filter

CODE	D [mm]	B [mm]	L [mm]	A [mm]	Packing I.	Packing II.	Weight [kg/pc]
TFI020XXXX	20	45,0	76,0	14,5	5	60	0,116
TFI025XXXX	25	45,0	82,0	16,0	5	40	0,134
TFI032XXXX	32	55,0	95,0	18,0	5	40	0,234

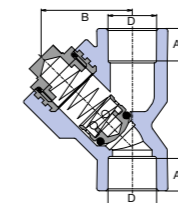

Back Flow Valve

CODE	D [mm]	B [mm]	L [mm]	A [mm]	Packing I.	Packing II.	Weight [kg/pc]
TZKL020XXX	20	45,0	76,0	14,5	5	60	0,136
TZKL025XXX	25	45,0	82,0	16,0	5	40	0,154
TZKL032XXX	32	55,0	95,0	18,0	5	40	0,266

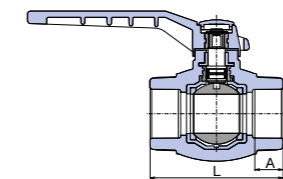

Ball Tap Plastic

CODE	D [mm]	A [mm]	L [mm]	Packing I.	Packing II.	Weight [kg/pc]
TVEK016RCT	16	13,0	59,5	10	60	0,092
TVEK020RCT	20	14,5	65,0	10	50	0,116
TVEK025RCT	25	16,0	71,0	10	40	0,168
TVEK032RCT	32	18,0	85,0	10	20	0,294
TVEK040RCT	40	20,5	100,0	5	10	0,544
TVEK050RCT	50	23,5	115,0	1	6	0,874
TVEK063RCT	63	27,5	134,0	1	5	1,278

* Material PP-RCT, lead-free brass.

Catalogue of Products

Standard Products for Potable (Cold) and Hot Water and for Heating (I.)

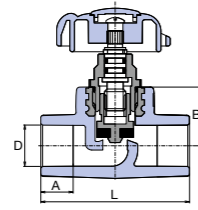

Straight - Way Valve

CODE	D [mm]	A [mm]	B [mm]	L [mm]	Packing I.	Packing II.	Weight [kg/pc]
TVE020XXXX	20	14,5	27,5	69,0	10	50	0,140
TVE025XXXX	25	16,0	30,0	80,0	10	30	0,192
TVE032XXXX	32	18,0	39,0	89,0	5	30	0,380
TVE040XXXX	40	20,5	41,0	112,0	5	15	0,542
TVE050XXXX	50	23,5	48,0	136,0	1	10	0,732
TVE063XXXX	63	27,5	60,0	162,0	1	8	1,330

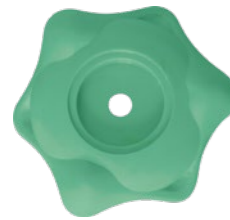

Spare parts / Flywheel

CODE	D [mm]	Packing I.	Packing II.	Weight [kg/pc]
TTOCVM02025S	20 - 25	1	5	0,015
TTOCVS03240S	32 - 40	1	5	0,028
TTOCVV05063S	50 - 63	1	1	0,041



Spare parts / Valve top part

CODE	D [mm]	Packing I.	Packing II.	Weight [kg/pc]
VRV020XXXX	20	1	5	0,080
VRV025XXXX	25	1	5	0,129
VRV032XXXX	32	1	5	0,211
VRV040XXXX	40	1	1	0,280
VRV050XXXX	50	1	1	0,293
VRV063XXXX	63	1	1	0,460

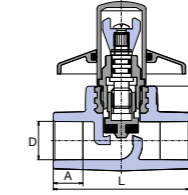

Shut Off Valve Straight with Chrome Cove

CODE	D [mm]	A [mm]	B [mm]	L [mm]	Packing I.	Packing II.	Weight [kg/pc]
TVEKPLK020	20	14,5	27,5	69,0	5	30	0,208
TVEKPLK025	25	16,0	30,0	80,0	5	20	0,270

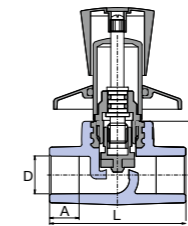

Shut Off Valve Deluxe Straight with Chrome Handle

CODE	D [mm]	A [mm]	B [mm]	L [mm]	Packing I.	Packing II.	Weight [kg/pc]
TVEPLR020X	20	14,5	27,5	69,0	5	20	0,338
TVEPLR025X	25	16,0	30,0	80,0	5	20	0,392

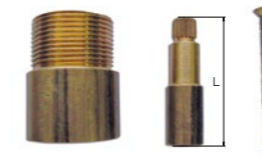

Valve Extension D 20, 25 mm

CODE	L [mm]	Packing	Weight [kg/pc]
VEPL020EXX	33	100	0,071

Extension for shut off valves straight Ø 20 and Ø 25 mm.

Catalogue of Products

Standard Products for Potable (Cold) and Hot Water and for Heating (I.)

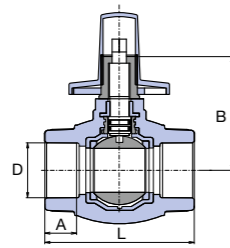

Shut off Ball Tap with Chrome Cover

CODE	D [mm]	A [mm]	B [mm]	L [mm]	Packing I.	Packing II.	Weight [kg/pc]
TVEKPLK020	20	14,5	67,0	69,0	5	30	0,254
TVEKPLK025	25	16,0	65,0	80,0	5	20	0,334

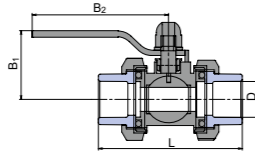
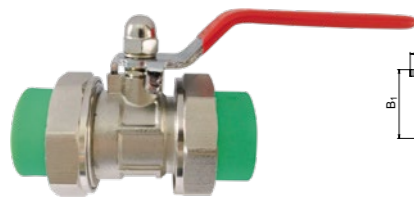

Shut off Ball - metal with plastic neck

CODE	D [mm]	L [mm]	B ₁ [mm]	B ₂ [mm]	Packing I.	Packing II.	Weight [kg/pc]
TVEKKS020X	20	81,0	46,0	80,0	5	25	0,293
TVEKKS025X	25	87,0	50,0	106,0	5	20	0,358

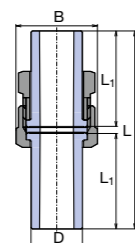

Coupling with Nut

CODE	D [mm]	B [mm]	L [mm]	L ₁ [mm]	Packing I.	Packing II.	Weight [kg/pc]
TRS020XXXX	20	30,0	82,0	40,0	20	100	0,088
TRS025XXXX	25	38,0	82,0	40,0	20	100	0,142
TRS032XXXX	32	46,0	92,0	45,0	10	50	0,212
TRS040XXXX	40	58,0	112,0	55,0	5	30	0,288

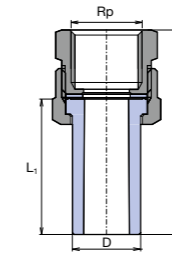

Spigot - Female Union

CODE	D [mm]	Rp	L [mm]	L ₁ [mm]	Packing I.	Packing II.	Weight [kg/pc]
TSI02020XX	20	1/2"	60,0	40,0	10	150	0,086
TSI02525XX	25	3/4"	62,0	40,0	10	100	0,136
TSI03232XX	32	1"	70,0	45,0	10	60	0,220

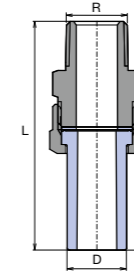

Spigot - Male Union

CODE	D [mm]	R	L [mm]	L ₁ [mm]	Packing I.	Packing II.	Weight [kg/pc]
TSE02020XX	20	1/2"	77,0	40,0	10	120	0,118
TSE02525XX	25	3/4"	80,0	40,0	10	70	0,196
TSE03232XX	32	1"	92,0	45,0	10	50	0,324

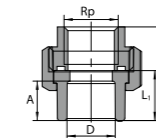

Screw Union with Socket - Female

CODE	D [mm]	Rp	L [mm]	L ₁ [mm]	Packing I.	Packing II.	Weight [kg/pc]
TSHI02020X	20	1/2"	37,5	19,5	10	100	0,122
TSHI02525X	25	3/4"	46,5	23,0	10	80	0,213

Catalogue of Products

Standard Products for Potable (Cold) and Hot Water and for Heating (I.)

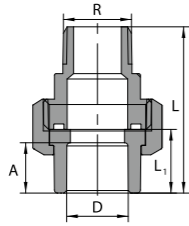

Screw Union with Socket – Male

CODE	D [mm]	R	L [mm]	L ₁ [mm]	Packing I.	Packing II.	Weight [kg/pc]
TSHE02020X	20	1/2"	52,5	19,5	10	100	0,142
TSHE02525X	25	3/4"	59,0	23,0	10	80	0,223

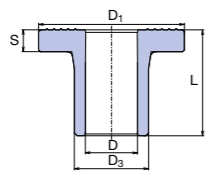

Flange Adaptor

CODE	D ₃ [mm]	L [mm]	D [mm]	D ₁ [mm]	S [mm]	Packing I.	Packing II.	Weight [kg/pc]
TLN040RCTX*	40	58,8	30,0	80,0	5,2	2	50	0,040
TLN050RCTX*	50	60,8	37,2	90,0	6,6	2	40	0,065
TLN063RCTX*	63	62,8	47,0	105,0	8,2	1	25	0,127
TLN075RCTX*	75	71,8	56,0	122,0	9,7	1	15	0,205
TLN090RCTX*	90	90,8	67,0	140,0	11,7	1	12	0,320
TLN110RCTX*	110	101,8	81,0	161,5	14,7	1	4	0,593

* Material PP-RCT.

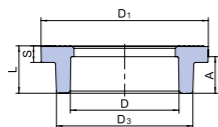

Flange Adaptor

CODE	D [mm]	D ₃ [mm]	L [mm]	D ₁ [mm]	S [mm]	A [mm]	Packing I.	Packing II.	Weight [kg/pc]
TLN125RCT**	125	157,0	55,0	190,0	16,0	40,0	1	8	0,548

* Material PP-RCT.

* Information about delivery on request.

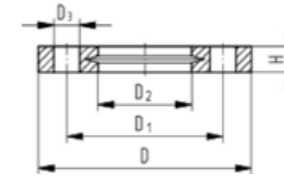

Flange PP-Glass Fiber Reinforced PN16

CODE	d [mm]	DN [mm]	D [mm]	D ₁ [mm]	D ₂ [mm]	D ₃ [mm]	H [mm]	Y	Packing	Weight [kg/pc]
FF700409W*	40	32	140	100	51	18	20	4	40	0,244
FF700410W*	50	40	150	110	62	18	22	4	30	0,297
FF700411W*	63	50	165	125	78	18	24	4	25	0,362
FF700412W*	75	65	185	145	92	18	26	4	19	0,487
FF700513W*	90	80	200	160	108	18	27	8	15	0,544
FF700514W*	110	100	220	180	128	18	28	8	13	0,643
FF700516W*	140	125	250	210	158	18	30	8	10	0,842

* Information about delivery on request.

Screw diameter M16 / Y – number of bore holes.

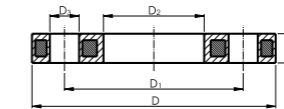

Flange PP – Steel PN 16

CODE	d [mm]	DN [mm]	D [mm]	D ₁ [mm]	D ₂ [mm]	D ₃ [mm]	H [mm]	Y	Packing	Weight [kg/pc]
FF700209W*	40	32	140	100	51	18	16	4	40	0,621
FF700210W*	50	40	150	110	62	18	20	4	30	0,722
FF700211W*	63	50	165	125	78	18	20	4	25	1,084
FF700212W*	75	65	185	145	92	18	20	4	19	1,349
FF700213W*	90	80	200	160	108	18	20	8	15	1,390
FF700214W*	110	100	220	180	128	18	20	8	13	1,407
FF700216W*	140	125	250	210	158	18	26	8	10	2,318

* Information about delivery on request.

Screw diameter M16 / Y – number of bore holes.

Catalogue of Products

Standard Products for Potable (Cold) and Hot Water and for Heating (I.)

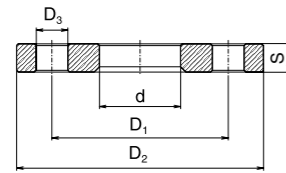

Flange

CODE	d	D ₁ [mm]	D ₂ [mm]	d	D ₃ [mm]	S [mm]	Y	Packing	Weight [kg/pc]
PRI040NXXX	40 / DN32	100,0	140,0	46,0	18,0	18,0	4	1	1,660
PRI050NXXX	50 / DN40	110,0	150,0	54,0	18,0	18,0	4	1	1,802
PRI063NXXX	63 / DN50	125,0	165,0	66,0	18,0	18,0	4	1	2,414
PRI075NXXX	75 / DN65	145,0	185,0	83,0	18,0	18,0	4	1	2,978
PRI090NXXX	90 / DN80	160,0	200,0	94,0	18,0	20,0	8	1	3,490
PRI110NXXX	110 / DN100	180,0	220,0	114,0	18,0	20,0	8	1	4,098
PRI125NXXX	125 / DN150	210,0	250,0	166,0	18,0	22,0	8	1	4,450

Y – number of bore holes

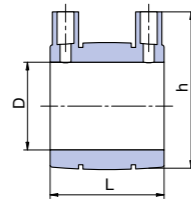

Electro – Fusion Socket

CODE	D ₁ [mm]	L [mm]	h [mm]	Packing I.	Packing II.	Weight [kg/pc]
ENAO20PPRCT*	20	70	52	1	100	0,040
ENAO25PPRCT*	25	70	57	1	80	0,050
ENAO32PPRCT*	32	80	65	1	60	0,070
ENAO40PPRCT*	40	90	74	1	50	0,100
ENAO50PPRCT*	50	100	85	1	30	0,160
ENAO63PPRCT*	63	110	97	1	20	0,260
ENAO75PPRCT*	75	120	114	1	25	0,410
ENAO90PPRCT*	90	130	130	1	18	0,510
ENA110PPRCT*	110	140	152	1	8	0,800
ENA125PPRCT**	125	151	168	1	6	0,950

* Material PP-RCT.

** Job-order manufacture, delivery date 30 days.

Catalogue of Products

Complete Offer of Fittings for Gypsum Wall Mounting (I.)

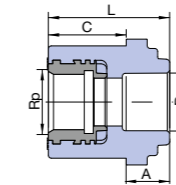

Reducing Sleeve for Gypsum Wall Mounting

CODE	D [mm]	Rp	A [mm]	C [mm]	L [mm]	Packing I.	Packing II.	Weight [kg/pc]
TZSO2020RCT	20	1/2"	14,5	26,0	40,5	1	50	0,102

Material PP-RCT, lead-free brass.

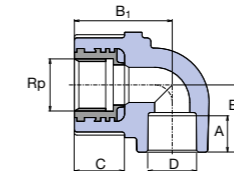

Elbow for Gypsum Wall Mounting

CODE	D [mm]	Rp	A [mm]	B ₁ [mm]	B ₂ [mm]	C [mm]	Packing I.	Packing II.	Weight [kg/pc]
TNKS020SRCT	20	1/2"	15,0	44,0	27,0	26,0	1	50	0,114

Material PP-RCT, lead-free brass.

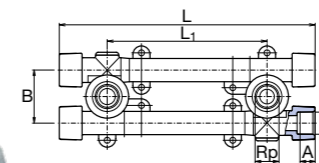

Wall Mounting Group with Tap Connectors for Gypsum Wall

CODE	D [mm]	Rp	A [mm]	B [mm]	L ₁ [mm]	C [mm]	L [mm]	Packing I.	Packing II.	Weight [kg/pc]
TNKK020SRCT	20	1/2"	14,5	49,0	100/135/150	26,0	234,0	1	10	0,320

Material PP-RCT, lead-free brass.

Catalogue of Products

Standard Products only for Potable (Cold) Water (II.)

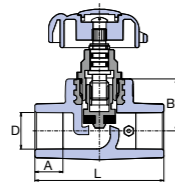

Straight – Way Valve with Drain Valve

CODE	D [mm]	Type	A [mm]	B [mm]	L [mm]	Packing I.	Packing II.	Weight [kg/pc]
TVEV040PXX	40	right	20,5	41,0	112,0	1	15	0,578
TVEV050PXX	50	right	23,5	48,0	136,0	1	10	0,788
TVEV063PXX	63	right	27,5	60,0	162,0	1	8	1,388
TVEV040LXX	40	left	20,5	41,0	112,0	1	15	0,572
TVEV050LXX	50	left	23,5	48,0	136,0	1	10	0,754
TVEV063LXX	63	left	27,5	60,0	162,0	1	8	1,416

Job-order manufacture, delivery date 30 days.

Catalogue of Products

Products for Temporary Use (non Standard) (III.)

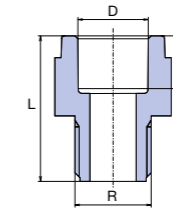

All-Plastic Reducer Male Thread

CODE	D [mm]	R	A [mm]	L [mm]	Packing I.	Packing II.	Weight [kg/pc]
SDG02020XX	20	1/2"	14,5	40,0	50	200	0,014
SDG02025XX	20	3/4"	14,5	38,0	20	380	0,012
SDG02525XX	25	3/4"	16,0	42,0	20	200	0,020
SDG03232XX	32	1"	18,0	54,0	20	100	0,038
SDG04040XX	40	5/4"	20,5	62,0	10	70	0,074
SDG05050XX	50	6/4"	23,5	63,0	10	60	0,094
SDG06363XX	63	2"	27,5	81,9	5	20	0,194



Plug – Short

CODE	D [mm]	Packing I.	Packing II.	Weight [kg/pc]
ZAGXXXXXX	1/2"	50	400	0,008

Including rubber seal.



Plug – Long

CODE	D [mm]	Packing I.	Packing II.	Weight [kg/pc]
ZAGDXXXXXX	1/2"	50	150	0,022

Including rubber seal.



Metal Sleeve (with Wood Screw)

CODE	D [mm]	Packing	Weight [kg/pc]
PRK02025XX	20 - 25	10	0,056
PRK03240XX	32 - 40	10	0,074
PRK06350XX	50 - 63	10	0,124



Metal Sleeve (Screw / Nut)

CODE	D [mm]	ГАЙКА [mm]	БОЛТ [mm]	Packing	Weight [kg/pc]
PRKB04853X	48 - 53	M8/10		50	0,078
PRKB07278X	72 - 78	M8/10		50	0,146
PRKB08792X	87 - 92	M8/10		50	0,180
PRKB102116	102 - 116	M8/10		50	0,238
VRUTM8100X			M8/100	100	0,023



Plastic Clip

CODE	D [mm]	Packing I.	Packing II.	Weight [kg/pc]
PRE016TXXX	16	50	300	0,004
PRE020TXXX	20	50	500	0,004
PRE025TXXX	25	50	500	0,006
PRE032TXXX	32	50	300	0,008



Plastic Clip with Tape

It is connected to other supports in one row

CODE	D [mm]	Packing I.	Packing II.	Weight [kg/pc]
PRP020TXXX	20	50	500	0,008
PRP025TXXX	25	50	500	0,008
PRP032TXXX	32	50	300	0,013
PRP040TXXX	40	50	400	0,016
PRP050TXXX	50	25	100	0,034
PRP063TXXX	63	25	100	0,046
PRP075TXXX*	75	1	-	0,084
PRP090TXXX*	90	1	-	0,114
PRP110TXXX*	110	1	-	0,136

* Information about delivery on request.

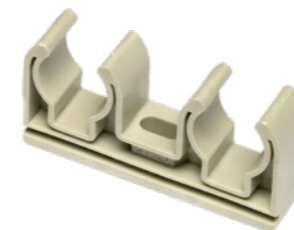

Plastic Double Clip

CODE	D [mm]	Packing	Weight [kg/pc]
PRDV0202XX	2×20	1	0,016
PRDV0252XX	2×25	1	0,022



Welding Machine Electronic R63 (for Paired Adapter)

CODE	Type	Power [W]	Attachment	Packing	Weight [kg/pc]
SVA063XXXX	R63	800	Ø 20 - 63	1	1,820

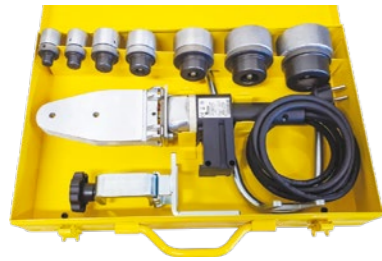

Welding kit R63 with nozzles 16 - 63 mm

CODE	Type	Power [W]	Attachment	Packing	Weight [kg/pc]
SVAKR63P1663	R63	800	Ø 16 – 63	1	9,223

Job-order manufacture, delivery date 30 days..



Repairing Set

CODE	Type	Packing I.	Packing II.	Weight [kg/pc]
OSAXXXXXXX	КОМПЛЕКТЪТ	1	50	0,186

Repairing set includes 5 pcs of repairing stakes Ø 12 mm and non-paired adapter Ø 12 mm.



Repairing Stakes

CODE	Ø [mm]	Packing I.	Packing II.	Weight [kg/pc]
OTXXXXXXX	12	5	100	0,029



Electrofusion Welding Machine - Elektra Light

CODE	W	Packing	Weight [kg/pc]
SVAELEKTRAL	Ø 20 - 125/160 mm	1	8,000

Job-order manufacture, delivery date 30 days.



Adapter Paired

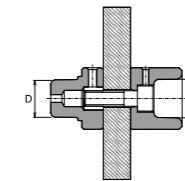

CODE	D [mm]	Packing	Weight [kg/pc]
NAP016XXXX	16	1	0,074
NAP020XXXX	20	1	0,078
NAP025XXXX	25	1	0,138
NAP032XXXX	32	1	0,164
NAP040XXXX	40	1	0,308
NAP050XXXX	50	1	0,333
NAP063XXXX	63	1	0,493
NAP075XXXX	75	1	0,653
NAP090XXXX	90	1	1,089
NAP110XXXX	110	1	1,681
NAP125XXXX	125	1	1,996



Set Holder for Manifolds

- Set contains
- ⊕ 4× plastic holder
 - ⊕ 4× bolt for holder
 - ⊕ 4× screw for holder
 - ⊕ 2× holder

CODE	Інтервал кріплення [mm]	Packing I.	Packing II.	Weight [kg/pc]
SETDRZROZX	200	1	5	0,403

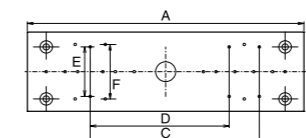

Assembly Plate for Elbow 90° for Wall Mounting



CODE	A [mm]	B [mm]	C [mm]	D [mm]	E [mm]	F [mm]	Packing I.	Packing II.	Weight [kg/pc]
DNPXXXXXXX	220,0	64,0	135,0	111,0	45,0	40,0	10	150	0,058

Catalogue of Products

Accessories (IV.)

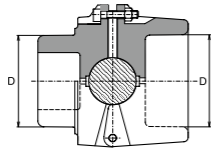

Adapter Non-Paired

CODE	D [mm]	Packing	Weight [kg/pc]
NA016CXXXX	16	1	0,130
NA020CXXXX	20	1	0,133
NA025CXXXX	25	1	0,178
NA032CXXXX	32	1	0,215
NA040CXXXX	40	1	0,379
NA050CXXXX	50	1	0,517
NA063CXXXX	63	1	0,822

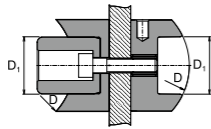

Adapter for Weld in Saddle / Paired

CODE	D [mm]	D ₁ [mm]	Packing	Weight [kg/pc]
SNNS06332X	63	32	1	0,298
SNNS07532X	75	32	1	0,296
SNNS09032X	90	32	1	0,296
SNNS11040X*	110	40	1	0,432
SNNS12540X**	125	40	1	0,519
SNNS12563X***	125	63	1	1,148

* for weld in saddle with diameter Ø 110/32, 110/40
 ** for weld in saddle with diameter Ø 125/32, 125/40
 *** for weld in saddle with diameter Ø 125/50, 125/63



Welding MP-125

CODE	Type	D [mm]	Packing	Weight [kg/pc]
SVAMP125XX	MP-125	63 - 125	1	37,200

MP 125 Includes frame, stand with welding machine with power consumption of 1400 W, case with accessories.
 Job-order manufacture, delivery date 30 days.



Welding Machine PRISMA 125

CODE	W	Packing	Weight [kg/pc]
SVA125XXXX	1 400	1	2,760

Job-order manufacture, delivery date 30 days.



Contact Thermometer "DT" Meter

CODE	Type	Packing	Weight [kg/pc]
TEPODXXXXX	DT-METER	1	0,940



Tightening Spanner with Band

CODE	Packing	Weight [kg/pc]
UKXXXXXXXXX	1	0,297



Pipe Cutter - Shear (PROFI)

CODE	D [mm]	Packing	Weight [kg/pc]
NU042PXXXX	16 - 40	1	0,383

Catalogue of Products

Accessories (IV.)



Pipe Cutter – Shear (PROFI M2)

CODE	D [mm]	Packing	Weight [kg/pc]
NU063XXXX	16 - 63	1	1,241



Pipe Cutter

CODE	D [mm]	Packing	Weight [kg/pc]
REZ050125X	50 - 125	1	1,400



Stabi Pipe Shaver

CODE	D [mm]	Packing	Weight [kg/pc]
REZS01620X	16 - 20	1	0,134
REZS02025X	20 - 25	1	0,156
REZS02532X	25 - 32	1	0,206
REZS03240X	32 - 40	1	0,266
REZS050XXX	50	1	0,302
REZS063XXX	63	1	0,352
REZS075XXX	75	1	0,386
REZS090XXX	90	1	0,634
REZS110XXX	110	1	0,870



Shavers To Drill Machine For Stabi Pipes

CODE	D [mm]	Packing	Weight [kg/pc]
REZS040VXX	40	1	0,290
REZS050VXX	50	1	0,882
REZS063VXX	63	1	0,406

PINTLE

CEPXXXXXX		1	0,020
-----------	--	---	-------



Drill For Weld In Saddle

CODE	D [mm]	Packing	Weight [kg/pc]
VNS032XXXX	32	1	0,200
VNS040XXXX	40	1	0,300
VNS063XXXX	63	1	0,740



Galvanized Trough

CODE	D [mm]	l [mm]	Packing I.	Packing II.	Weight [kg/pc]
ZLSP20XXXX	20	2000	1	25	0,331
ZLSP25XXXX	25	2000	1	25	0,428
ZLSP32XXXX	32	2000	1	25	0,516
ZLSP40XXXX	40	2000	1	25	0,607
ZLSP50XXXX	50	2000	1	25	0,732
ZLSP63XXXX	63	2000	1	25	0,879



Sealing Teflon Fibre

CODE	Packing II.	Weight [kg/pc]
TTN50XXXX	50	0,053
TTN150XXXX	150	0,126

Wavin Ekoplastik PP-R/PP-RCT Piping System diameters 160 - 250 mm

The system consists of monolayer pipes, multilayer pipes and fittings with diameters between 160 - 250 mm and is manufactured from the PP-RCT material.

The system is intended for pressure distribution systems of potable (cold) water, hot water, compressed air, cooling water and air conditioning. The system is compatible with butt welding techniques.

- Estimated delivery time for the listed product range is 30 days.
- Standard products (I.) are covered by a 10-year warranty period.
- Other products (IV.) are covered by a 2-year warranty period.



Advantages of the system

- Pipes and fittings made from PP-RCT (type 4), new generation polypropylene material)
- Pipes and fittings of larger diameters than 125 mm are designed for butt welding
- Same flow profile for both fittings and monolayer pipes - minimal pressure losses

All 160 - 250 mm products (except for electrofusion couplings) will be replaced by the same products in grey colour during 2024.

160 - 250 mm pipes can be made to order also in SDR 7,4 and SDR 9.

Catalogue of Products

Products for Potable (Cold) and Hot Water, compressed air, cooling and air conditioning (I.)

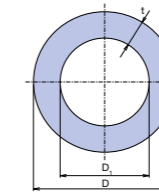

Wavin Ekoplastik PP-RCT pipe
S 5 / SDR 11

CODE	D [mm]	D ₁ [mm]	t [mm]	l [mm]	Packing [m]	Weight [kg/pc]
TTR160RCTS5	160	130,8	14,6	4 000	4	6,420
TTR200RCTS5	200	163,6	18,2	4 000	4	9,950
TTR250RCTS5	250	204,6	22,7	4 000	4	15,500

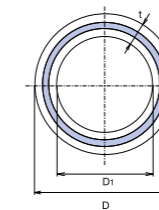
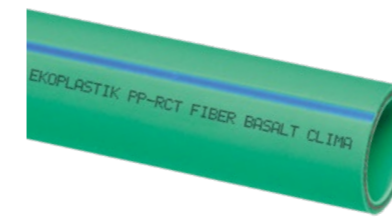

Wavin Ekoplastik PP-RCT Basalt Clima pipe
S 5 / SDR 11

CODE	D [mm]	D ₁ [mm]	t [mm]	l [mm]	Packing [m]	Weight [kg/pc]
TTRFBC160RCT	160	130,8	14,6	4 000	4	7,185
TTRFBC200RCT	200	163,6	18,2	4 000	4	11,157
TTRFBC250RCT	250	204,6	22,7	4 000	4	16,870

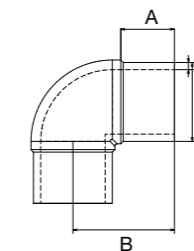

Elbow 90° PP-RCT (Butt Fusion)
S 5 / SDR 11

CODE	D [mm]	A [mm]	B [mm]	t [mm]	Packing [pc]	Weight [kg/pc]
TKO16090XXX	160	103	210	14,6	1	3,000
TKO20090XXX	200	115	239	18,2	1	5,200
TKO25090XXX	250	116	250	22,7	1	10,500

Catalogue of Products

Products for Potable (Cold) and Hot Water, compressed air, cooling and air conditioning (I.)

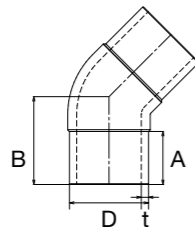

Elbow 45° PP-RCT (Butt Fusion)
S 5 / SDR 11

CODE	D [mm]	A [mm]	B [mm]	t [mm]	Packing [pc]	Weight [kg/pc]
TKO16045XXX	160	107	175	14,6	1	2,400
TKO20045XXX	200	118	190	18,2	1	4,000
TKO25045XXX	250	130	215	22,7	1	7,100

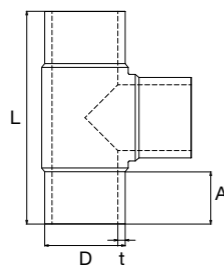

Tee PP-RCT (Butt Fusion)
S 5 / SDR 11

CODE	D [mm]	A [mm]	B [mm]	t [mm]	Packing [pc]	Weight [kg/pc]
TTK160XXXXX	160	104	423	14,6	1	4,100
TTK200XXXXX	200	117	501	18,2	1	7,200
TTK250XXXXX	250	131	595	22,7	1	13,600

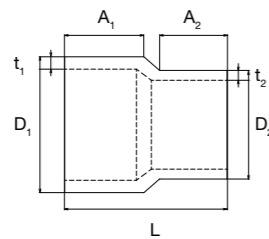

Reducer PP-RCT (Butt Fusion)
S 5 / SDR 11

CODE	D ₁ [mm]	D ₂ [mm]	t ₁ [mm]	t ₂ [mm]	A ₁ [mm]	A ₂ [mm]	L [mm]	Packing [pc]	Weight [kg/pc]
TRE1160110X	160	110	14,6	-	106	92	226	1	1,200
TRE1160125X	160	125	14,6	-	105	93	220	1	1,328
TRE1200160X	200	160	18,2	14,6	117	100	240	1	2,100
TRE1250160X	250	160	22,7	14,6	60	56	162	1	3,000
TRE1250200X	250	200	22,7	18,2	128	116	274	1	3,600

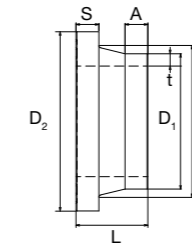

Flange Adapter PP-RCT (Butt Fusion)
S 5 / SDR 11

CODE	D ₁ [mm]	D ₂ [mm]	D ₃ [mm]	S [mm]	A [mm]	t [mm]	L [mm]	Packing [pc]	Weight [kg/pc]
TLN160XXXXX	160	212	175	27	27	18,2	85	1	0,960
TLN200XXXXX	200	268	232	34	50	14,6	130	1	2,300
TLN250XXXXX	250	320	285	36	38	22,7	121	1	3,100

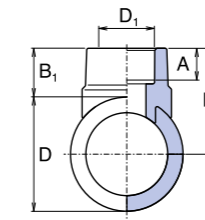

PP-RCT Weld in Saddle
S 5 / SDR 11

CODE	D [mm]	D ₁ [mm]	A [mm]	B ₁ [mm]	B [mm]	Packing [pc]	Weight [kg/pc]
TNS16040XX	160	40	16,5	35,0	115,0	1	0,054
TNS16050XX	160	50	18,5	41,5	121,5	1	0,095
TNS16063XX	160	63	22,0	41,8	121,8	1	0,155
TNS20050XX	200	50	15,5	41,5	141,5	1	0,090
TNS20063XX	200	63	22,0	41,8	141,8	1	0,159
TNS20075XX	200	75	25,0	45,0	145,0	1	0,220
TNS20090XX	200	90	27,0	61,0	161,0	1	0,505
TNS25063XX	250	63	22,0	41,8	166,8	1	0,145
TNS25075XX	250	75	25,0	45,0	170,0	1	0,215
TNS25090XX	250	90	27,0	61,0	186,0	1	0,485
TNS250110X	250	110	31,0	66,8	191,8	1	0,660

Catalogue of Products

Products for Potable (Cold) and Hot Water, compressed air, cooling and air conditioning (I.)

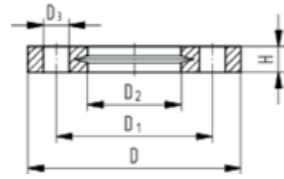

Flange PP-Glass Fiber Reinforced PN16

CODE	d [mm]	DN [mm]	D [mm]	D ₁ [mm]	D ₂ [mm]	D ₃ [mm]	H [mm]	Y	Packing [pc]	Weight [kg/pc]
FF700517W*	160	150	285	241	178	22	32	8	1	1,200
FF700519W*	200	200	340	297	235	22	34	8	1	1,400
FF700521W*	250	250	395	350	288	22	38	12	1	2,052

* Information about delivery on request.

Flange PP - Glass Fiber Reinforced (30% GF) / Y – number of bore holes.

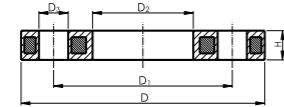

Flange PP-Steel Plate Reinforced PN16

CODE	d [mm]	DN [mm]	D [mm]	D ₁ [mm]	D ₂ [mm]	D ₃ [mm]	H [mm]	Y	Packing [pc]	Weight [kg/pc]
FF700217W*	160	150	285	241	178	22	26	8	1	3,491
FF700219W*	200	200	340	297	235	22	29	8	1	5,600
FF700221W*	250	250	395	350	288	22	32	12	1	6,632

* Information about delivery on request.

Screw diameter M16 / Y – number of bore holes.

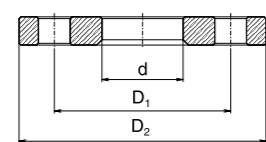

Flange

CODE	Type	D ₁ [mm]	D ₂ [mm]	d [mm]	Y	Packing [pc]	Weight [kg/pc]
PRI160NXXX	160	240	285	178	10	1	6,800
PRI200NXXX	200	355	405	238	12	1	10,500
PRI250NXXX	250	355	405	292	12	1	12,900

Y – number of bore holes

Catalogue of Products

Accessories (IV.)

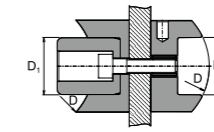
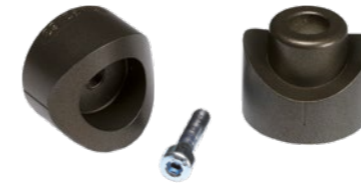

Adapter for Weld in Saddle / Paired

CODE	D [mm]	D ₁ [mm]	Packing [pc]	Weight [kg/pc]
SNNS16040X	160	40	1	0,545
SNNS16050X	160	50	1	0,780
SNNS16063X	160	63	1	1,200
SNNS20050X	200	50	1	0,785
SNNS20063X	200	63	1	1,220
SNNS20075X	200	75	1	1,665
SNNS20090X	200	90	1	2,885
SNNS25063X	250	63	1	1,220
SNNS25075X	250	75	1	1,680
SNNS25090X	250	90	1	2,930
SNNS250110	250	110	1	3,530



Drill for Weld in Saddle

CODE	D [mm]	Packing [pc]	Weight [kg/pc]
VNS040XXXX	40	1	0,300
VNS050XXXX	50	1	0,500
VNS063XXXX	63	1	0,640
VNS075XXXX	75	1	0,710
VNS090XXXX	90	1	0,870
VNS110XXXX	110	1	1,220

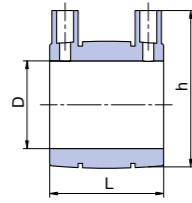

**Electrofusion Coupling
S 5 / SDR 11**

CODE	D [mm]	L [mm]	h [mm]	Packing [pc]	Weight [kg/pc]
ENA160PPRCT	160	176,0	205,0	1	1,300
ENA200PPRCT	200	187,0	245,0	1	1,900
ENA250PPRCT	250	243,0	315,0	1	4,500



**Basic 250 Easy Life
Assembly Jig**

CODE	Type	Packing [pc]	Weight [kg/pc]
SVAMP250XX	Basic 250 Easy Life	1	100

The assembly jig comprises the following:

- ⦿ A jig with four clamps and two hydraulic cylinders with non-drip quick couplers
- ⦿ One extractable heating plate
- ⦿ One extractable milling cutter with a safety microswitch
- ⦿ One electrohydraulic gearcase with a clamp opening and closing lever
- ⦿ Hydraulic hoses with non-drip quick couplers
- ⦿ SmartLock adapters (Ritmo patent) for the 75 - 225 mm diameters



**Basic 315 Easy Life
Assembly Jig**

CODE	Type	Packing [pc]	Weight [kg/pc]
SVAMP315XX	Basic 315 Easy Life	1	123

The assembly jig comprises the following:

- ⦿ A jig with four clamps and two hydraulic cylinders with non-drip quick couplers
- ⦿ One extractable heating plate
- ⦿ One electrohydraulic gearcase with a clamp opening and closing lever
- ⦿ One electrohydraulic gearcase with a clamp opening and closing lever
- ⦿ Hydraulic hoses with non-drip quick couplers
- ⦿ SmartLock adapters (Ritmo patent) for the 90 - 280 mm diameters, Ø 250 mm transition



- ⦿ For production and testing is used standard EN ISO 15874. Requirements from this standard are stated in PN 01 (Internal Company Standard).
- ⦿ The application and assembling of products have to conform to assembly regulations of Wavin PP-R/PP-RCT system.
- ⦿ System of quality is certified in accordance with ISO 9001-2000
- ⦿ Extended warranty period 10 years for standard products (I, II).
- ⦿ Common warranty period 2 years for other products (III, IV).

ВЖИВАЊИ СКОРОЧЕННЯ:

- CODE – purchasing code
- S (PN) – serie / pressure line
- Packing I. – small packing
- Packing II. – big packing
- G – female cylindrical thread no sealing on threads
- Rp – female cylindrical thread sealing on threads
- R – male conical thread sealing on threads

Wavin Czechia is constantly improving and modernizing its products, therefore reserves the right to modify and change specifications of its products without prior notice. All information published in this edition of the catalog on the moment of submission of materials for printing, fully corresponds the current volume of the assortment and the list of technical product parameters. The specified catalog is not commercial proposal, in accordance with the Civil Code, but only contains product information.

Discover our broad portfolio at [wavin.com](https://www.wavin.com)

- Water management
- Heating and cooling
- Water and gas distribution
- Waste water drainage
- Cable ducting



wavin

orbis 

Wavin is part of Orbis, a community of companies working together to tackle some of the world's most complex challenges.

We are bound by a common purpose:
To Advance Life Around the World.

Wavin Czechia s.r.o. | Rudeč 848 | 277 13 Kostelec nad Labem | Tel.: +420 326 983 111
Fax: +420 326 983 110 | E-mail: info.cz@wavin.com | www.wavin.cz

Wavin operates a programme of continuous product development, and therefore reserves the right to modify or amend the specification of their products without notice. All information in this publication is given in good faith, and believed to be correct at the time of going to press. However, no responsibility can be accepted for any errors, omissions or incorrect assumptions.

© 2023 Wavin Wavin reserves the right to make alterations without prior notice. Due to continuous product development, changes in technical specifications may change. Installation must comply with the installation instructions.